

Three-piece chemical cans for the packaging of paints, lacquers, thinners, adhesives, industrial pastes, soaps and grease and plant protection products.



Three-piece chemical cans are manufactured from electrolytic tinplate covered with tin.

The cans are manufactured by the process of welding the longitudinal seam and by sealing the bottom or lid, applying new production technologies in line with good production practices, respecting the specific demands of the customer.

The outside of the can is protected by lacquer coating, with or without lithographic print, as per customer specifications.

We offer stay-tabs and lids with plastic caps.

*Top product quality
demands top quality
packing cans*

*Can quality and customer
satisfaction come first*

Chemical can quality

We apply process and finished product quality control of chemical cans by standardised testing methods at a physiochemical laboratory. Lacquer protection of the can's external weld.

The quality of raw materials sourced and of the finished product is guaranteed through cooperation with trusted suppliers and physical and chemical analyses of the raw materials sourced and of the finished product.

Product traceability throughout the entire manufacturing process, *from sheet to can.*

New product development

In collaboration with customers and applying new technologies and tools we are able to develop chemical cans of various shapes and sizes.

*Cans are indefinitely
recyclable as steel does
not lose its attributes
during recycling.*

*Steel recycling contributes
to the preservation of the
natural environment.*



THREE - PIECE CHEMICAL CAN

TECHNICAL SPECIFICATION

Diameter D [mm]	Height of tin can H [mm]	Volume V [ml]	Note
73	40 - 200	100 - 700	BOTTOM WITH PL. CAP, INSERTED TOP LID, FLIP TOP LID, INSERTED TOP LID WITH RING
83	40 - 200	150 - 950	BOTTOM WITH PL. CAP
84	40 - 210	160 - 1000	BOTTOM WITH PL. CAP
99	40 - 260	150 - 1700	BOTTOM WITH PL. CAP, INSERTED TOP LID, FLIP TOP LID, INSERTED TOP LID WITH RING
108	40 - 300	275 - 2400	BOTTOM WITH PL. CAP
130	50 - 260	500 - 3000	FLIP TOP LID
140	50 - 280	600 - 3750	BOTTOM WITH PL. CAP
163	50 - 400	625 - 7000	BOTTOM WITH PL. CAP, WIRE HANDLE ON THE LID, INSERTED TOP LID WITH RING

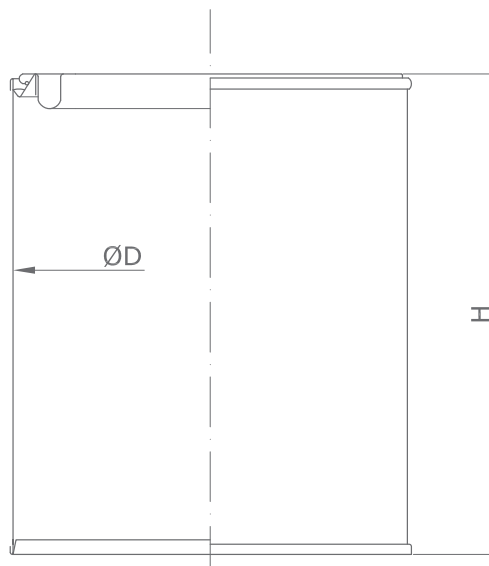

LimSamobor

From sheet to can